

Iraq Rebuilding Office – Scandinavia

مكتب اعادة اعمار العراق - أسكننأفيا

Trade consultant, sale & troubleshooting

استشارات هندسية / طبية ووكالات تجارية عالمية



E-mail: info@irak-genopbygning.dk

Homesite: www.irak-genopbygning.dk

Phone: (+45) 30 22 23 75

المعلومات ومواصفات الفنية لعرض المستشفى الطبي العائم

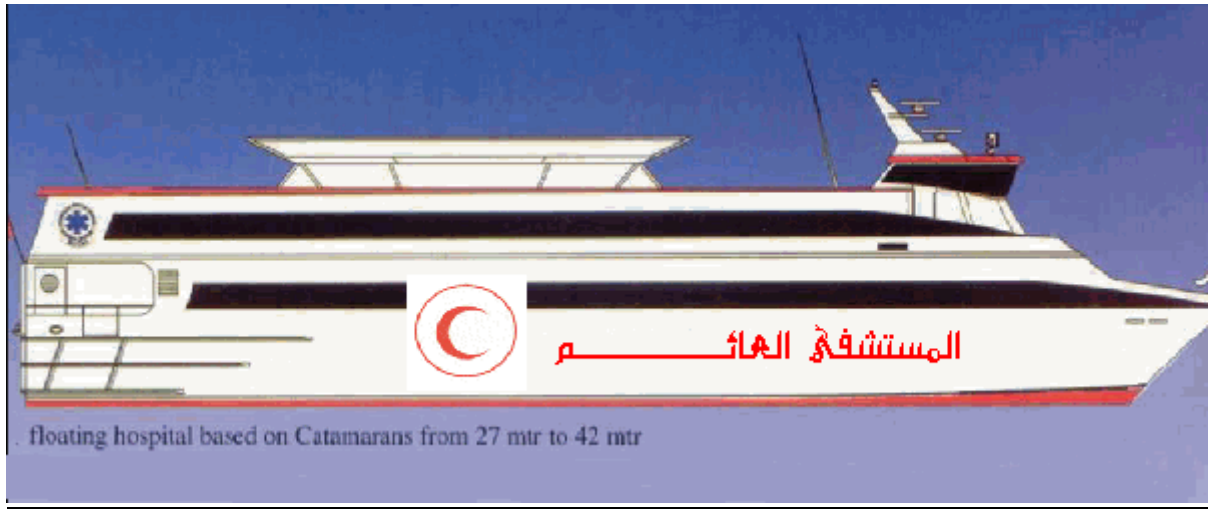

Scope of Supply.

The NorCat can be delivered in different sizes from 27 m long up to 42 m long.

Sea Lord Catamaran

The Sea Lord Catamaran is designed with symmetric hulls and optimized for low hull resistance, sea keeping properties comfort.

The vessel to be built of aluminium, all welding to be in conformity with approved drawings from DNV rules.

Welded construction in structural parts.

Shell plating to be strengthened by way of sea chests, drain plugs etc.

Drainage holes to be made in all frames/ supports where appropriate.

Main Dimension

Length overall 41,77 meters

Beam overall 13,47 meters

Beam moulded 13,17 meters

Draught (propeller) 2,30 meters

Draught moulded 3,90 meters

Speed and Performance

Max speed 24 knots with 2 x 1050 kW

Upper deck

Small helicopter landing area
 Stretcher lift to boat and main deck
 Communication office
 Wheelhouse

Boat Deck

Gallery with cold storage and storage
 Dining Room for 31 people
 TV Lounge
 Cabins, 4 beds 2 cabins
 Cabins, 1 beds 1 O cabins
 Captains Cabin & Lounge 1 cabin
 Toilet & Shower 5 cabins
 Storage 2 cabins
 One special fast pick up boat with arrangement for stretcher

Main Deck

Two Operating Rooms with common Anesthesia and Scrub Up area
 ICU with 3 beds
 Clean Utility
 Dirty Utility
 Recovery with 7 beds
 Storage, 3 Rooms
 Blood Bank
 Laboratory incl. storage

Locker incl. toilets & shower
 Doctor ICU
 Resuscitation / Examination
 Resuscitation / X-ray
 Examination, 3 rooms
 Reception and Waiting Area for 28 people, incl. 2 toilets
 Arrangement for ambulances with hydraulic ramp for beach landing

Under main deck Morgue Medical
 stores Refrigerated/freezing stores
 for food

Equipment

To equip each of the above mentioned rooms the floating hospital may include – amongst others –the below mentioned modules:

Surgical module

Each surgical module contains sufficient medical equipment to establish an operating theatre with two operating tables.

This is the only module containing lighting equipment, two operating- and two examination lamps.

Two autoclaves allow for continuous sterilization of instruments and textiles. The autoclaves can be heated either electrically or with kerosene, gas etc.

The module also contains electrical suction apparatus, microscope and centrifuge.

Nursing module

Each nursing module contains all the necessary nursing equipment to establish and maintain a surgical ward for 50 inpatients.

Medical Officer module

Each medical officer module contains equipment for establishing a simple outpatient department for diagnostics, and where triage and emergency treatment can be provided.

X-ray module

The X-ray module contains a complete X-ray department including X-ray machine, manual developing equipment, darkroom equipment, chemicals, films, light boxes and protection equipment.

Sterilization module

The Sterilization module includes equipment for Clean and Dirty Utility such as steam autoclave, working table, heat sealer and instrument table.

Operating Room module

The Operating module contains a complete Operating department including operating table , ceiling light, diathermy incl. trolley and acc. Electrotom 640, anaesthesia machine w/ respirator, ECG –monitor, defibrillator, supply of O2 and N2O, etc.

Intensive Care Unit module

The module contain equipment for treatment of three patients with volume respirators, defibrillator, ECG monitor, trolley w/ drawers, infusion stand, suction ejector, O2-flowmeter, catheter holder, infusion pump.

Emergency and Triage module

The Emergency and Triage module include equipment to perform clinical assessment that determines the time and sequence in which patients should be admitted. Equipment include portable consultation lamp, examination table, small mobile table for prescriptions, set of otoscope / ophthalmoscope, administration desk for arriving patients, portable pulseoxymeter, external cardiac defibrillator, portable ventilator, portable 3 channel ECG, emergency kit, etc.

Pharmacy Module

This module will contain drugs and other pharmaceutical items. The contents will be adjusted to reflect the geographic areas of operations of the NorCat, as well as its intended use.

Dental Unit

This module consists of three modules:

- Dental Tools
- Dental Equipment
- Dental Consumables

Office Module

The module contains general office supplies

Maintenance Module

Equipment includes necessary tools and spare parts to maintain the medical equipment.

Eaundry Unit

The module contains equipment for washing, drying and ironing.

Kitchen

The module contains general kitchenware.

Dining Module

The module contains general dining tools.

ENT

The module contains equipment for examination of ear, nose and throat.

Eyeclinic

The module contains general equipment for eye examinations.

Laparoscope

The module contains instruments for minimal invasive surgery and examinations.

To make a complete an installation with Power Supply, water and sanitation will have following optional equipment:

Optional Supply

Helicopter pad helicopter landing platform

Ambulance

Landing ramp for various types of vehicles



Effective Contract Date

The effective contract date is the date when all of the following has been adhered to:

- A contract has been duly signed by both parties
- We have received advance payment according to the terms of payment listed above
- Prices have been fixed in accordance with current and applicable exchange rates
- All technical details have been settled

Time of Delivery

The equipment shall be ready for shipment approx. 8- 10 months after effective contract date.

Validity

This quotation is valid for acceptance before 01.09.2005

Guarantee

The guarantee period is one (1) year from the date of shipment.

Our offer is given subject to agreement on final contract to be approved by national authorities and our board of directors.

Price Basis

The prices are based on delivery: EX Works (INCOTERMS 2000)

Terms of Payment

Payment is irrevocable L/C accepted by a European Bank or after agreement.

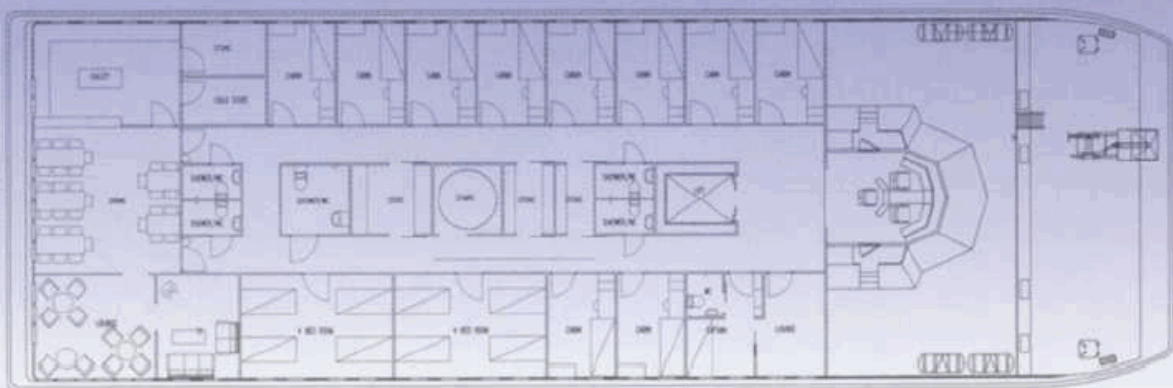

الطابق العلوي من المستشفى العائم - بالامكان تصميم الطابق بطريقة تفي احتياجات ومواصفات الزبون

Upper deck designed as our customers/ users want it

The NorCat can be delivered in different sizes from 27 m long up to 42 m long.

